

WRITTEN FOR ALADDIN LOVERS BY
Mr. Stan Walker
Cottage Kitsch
P. O. Box 70
Kearney, Ontario POA 1MO
Canada
Telephone: 1-877-867-0666
E-mail: sales@keroseneconnection.com

Aladdin®

Some Tips on Changing Wicks in Aladdin Lamps

Dear Aladdin Customer,

The parts shown right are common parts to most all Aladdin one inch kerosene oil burners. The shape shown may be somewhat different in appearance from your particular model, but your burner will have a gallery, a flame spreader, an outer wick tube, a burner basket, a wick and a wick raiser. If any of these parts are missing, they will need to be replaced in order for your Aladdin to operate safely and correctly.

In order to determine the model number for your Aladdin, please look on the face of the burner knob. It will have either a letter or a number (a few have both) and that is the information you will need to order the correct parts from your Aladdin lamp dealer.

ALADDIN 1-INCH ROUND WICKS AND MODELS THEY FIT

Burner Models Nos. 23 and 23A take No. N230 Wick

Burner Models Nos. 21 and 21c take No. R199 Wick

Burner Models A, B, and C take No. N151 Wick

Note: N151 Wick can also be used in 21 & 21c

Burner Models Nos. 7, 8, 9, 10, 11 and 12 take No. N198 Wick

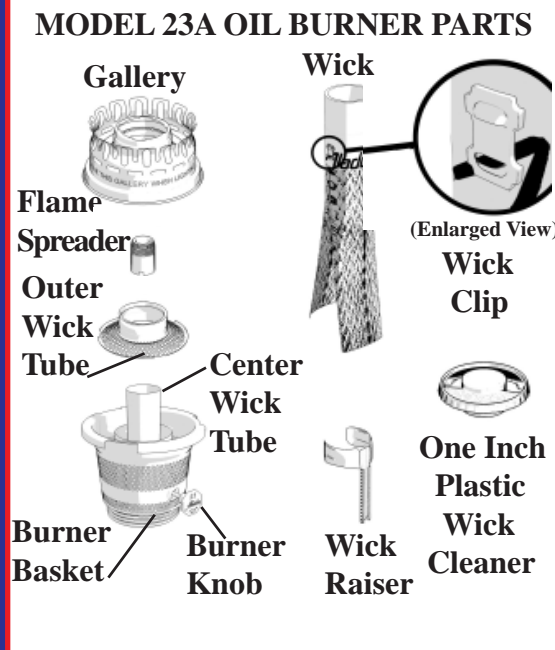

OLDER ALADDIN LAMP MODELS (1908 to 1916)

Wicks to fit older Aladdin kerosene mantle lamps Models 1, 2, 3, 4, 5 and 6, made prior to 1916 required that a No. N198 Wick be modified to fit as follows: (a) Remove the metal mounting tabs located on the side of the wick and (b) peel off the the outer reinforcing fabric tape. The tabs are attached to the wick by means of four (4) small metal staples, which are easily clipped off with a small pair of wire sidecutters. (c) After you have removed the tabs and outer fabric tape and the wick still fits too tightly, then it will be necessary to also remove the inner reinforcing fabric tape. Once that is done, your newly modified Aladdin wick should fit without binding on the center wick tube. **IMPORTANT NOTE: Install flame spreader before attempting to insert wick into burner. This will keep wick from binding on the top of center wick tube during installation.**

SOME GENERAL TIPS ON INSTALLING WICKS IN ALADDIN KEROSENE MANTLE LAMPS

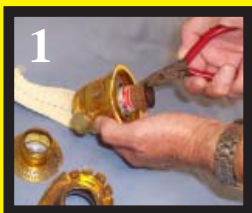

1. Remove old wick by first removing (a) gallery, (b) flame spreader and (c) outer wick tube and pulling out wick from the top. It may be necessary to grasp the old wick with a pair of needle nosed pliers in order to remove it from the lamp. **CAUTION: The flame spreader is often caught inside the old wick and be careful not to discard this part, as it is necessary to operate your lamp safely and correctly.**

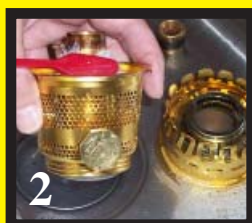

2. Wash the burner to remove any accumulated oil and dirt. Wisk brand liquid laundry detergent works well mixed 10:1 (10 parts water to one part Wisk) and then allow the burner to soak for 15-20 minutes. Give it a good scrubbing with an old tooth brush, then rinse in clean water and allow to dry.

GO TO STEP 3 ON REVERSE OF PAGE.

Some Tips on Changing Wicks in Aladdin Lamps

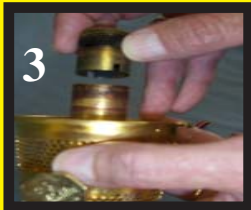

3. Re-install the flame spreader into the center wick tube. Carefully inspect the flame spreader for dents and cracks. If any are present, then replace with a new flame spreader, so that your Aladdin will operate correctly. **NOTE: The flame spreader acts as a guide for the wick to be easily installed over the center wick tube and prevents the inner fabric tape from catching on the tube's top edge.**



4. Use the paper tails glued on the bottom of the wick to help pull down the long cotton tails through the wick channel holes located in the bottom of the burner. Use a long, thin object (like a slender letter opener) to help guide the tails down through the burner channels. Then, grab the paper tails and pull through the bottom opening. If necessary, use needled-noised pliers to pull down further. **DO NOT pull the wick completely down, as you have to first attach the wick raiser arms to the wick clips.** NOTE: It may also be necessary to insert a slip of paper between the wick and the gear on the inside of the knob (or pull out the knob all the way) while you are pulling the wick down to prevent the woven wick fabric from snagging on the teeth of the gear.



5. After installation of the wick is started within the burner, install the wick raiser so that the elongated gear channel arm is pointing downward. **SEE SPECIAL NOTES AND TRICKS (below) for easier installation.** Also, be careful not to roughen up the top edge of the wick, as it is important that the top edge be completely smooth in order to produce an even flame that lights up the Aladdin incandescent mantle. Trim off any loose threads with a pair of sharp scissors, again being careful not to roughen up the top edge of the wick.

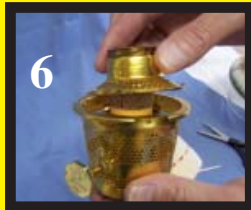

6. After the wick raiser is correctly attached to the wick, and it is lined up over the gear inside the knob, gently pull the wick tails down so that the gear engages fully onto the wick raiser teeth. Check this by turning the knob back and forth. If the wick smoothly goes up and down by turning the burner knob, your wick is correctly installed. Then re-install the outer wick tube and turn to right to lock into place.

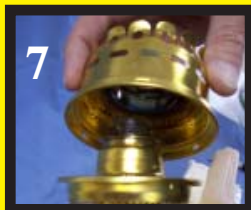

7. Next re-install the gallery by first lining up the three notches on the bottom with the cutouts on top of the burner basket. Then seat the gallery squarely into the notches and turn to the right to lock. Now your re-wicked Aladdin burner is ready to be returned to your lamp fount. **IMPORTANT: Allow at least 30 minutes for the new wick to soak in the kerosene of the lamp fount before lighting. Otherwise, you may experience a weak flame and poor light.**

SPECIAL NOTES AND TRICKS

Model #23 Burner—After you have installed the N230 #23 wick part way through the bottom of the burner, a little trick to easier installation of the wick raiser is to twist/rotate the wick about 30 degrees to make it easier to get the wick raiser (carrier) arms past the mounting clips of the wick. Once the arms are even with the clips, you can rotate the wick back and forth so that the arms engage the clips themselves. Be careful not to bend the wick raiser arms too much, otherwise, the wick raiser will have to be removed and the arms re-bent (re-tensioned) to fit properly.

Aladdin... Light Where You Need it, When You Need it... THAT'S ALADDIN!!!

ALADDIN MANTLE LAMP COMPANY

681 International Blvd., Clarksville, TN 37040, USA

Tel: 800-457-5267 FAX: 931-647-4517

www.aladdinlamps.com E-Mail: sales@aladdinlamps.com